

Saddle
1:1

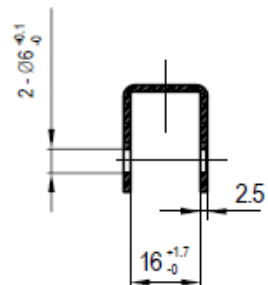

- Technical requirement
 1/ No scratch on surface,
 2/ All riveted point flexible
 3/ Material: SUS316,
 4/ Tip force: 12±1Nm
 5/ Tube length 1300mm,
 6/ Adaptor material: bronze

±0.3	±0.23	±0.18	±0.15	±0.12	±0.10	±0.08	±0.06	±0.04
≥180	180-120	80-120	30-80	18-30	10-18	6-10	3-6	0-3
Tolerance unless otherwise specified								

Edit	Mark	Signature	Date	Wiper arm			
Design		Zou Hongwei	2008.08.15				
Proofread		He Guozhong	2008.08.16	Weight		Model	19 190 01
Review		Zheng Ming	2008.08.16	View		Drawing#	
Approval		Chen Linbin	2008.08.16	Scale	1:1	Edition	A
						Pages	

Date