

# TSUNAMI

## DUAL OUTLET AERATOR PUMPS

The advantage of the dual outlet is that you can feed multiple applications through a single thru-hull fitting. The Tsunami second outlet is integrated into the pressure chamber, so it looks – and pumps – like part of the aerator. Both of the pump's outlets are engineered for the precise position and angle that will deliver optimum performance.

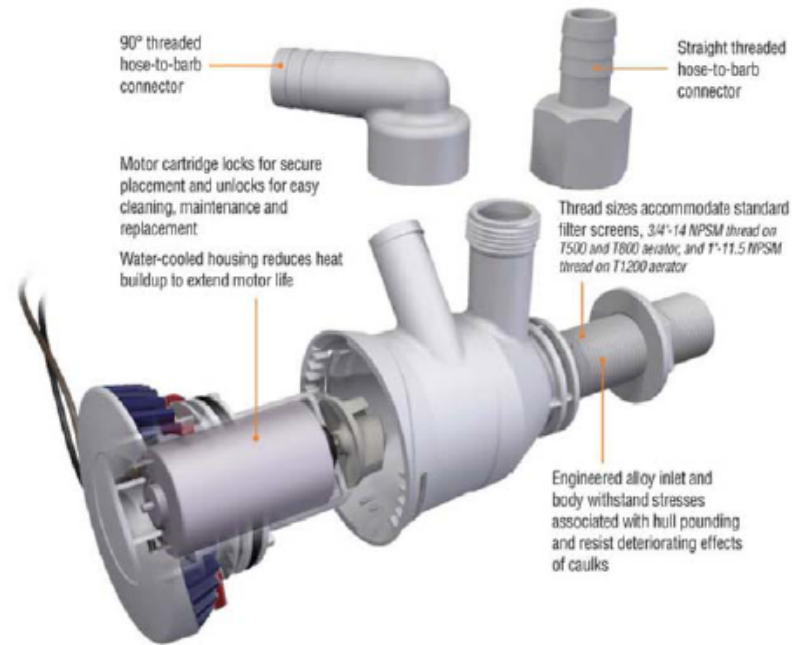

### NMMA Numbers

Part No.	NMMA No.	IMCI (CE) Certificate No.
4672	Pending	IGPATT003

### Specifications

Outlet	Amp Draw	GPH Output @ Design Voltage 13.6 VDC				GPH Output @ Nominal Voltage 12.0 VDC				Fuse Size			
		Both Outlets Open											
		0 ft.	3.3 ft.	6.7 ft.	Max Head	0 ft.	Amp Draw	0 ft.	3.3 ft.		6.7 ft.	Max Head	0 ft.
Upper	3.0	750	600	460	13 ft.	880	2.5	670	500	390	11 ft.	770	4-amp

### Pump Dimensions

Part No.	Inlet Length	Inlet Dia.	A	B	C	D	E	F	G	H
4672	3-1/2"	3/4"	3-1/4"	3"	4-1/8"	4-1/4"	4"	3/4-14 NPSM	3/4" Barbed .554" I.D.	3/4-14 NPSM .620" I.D.

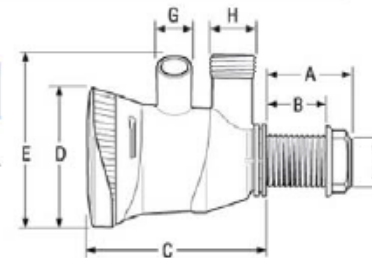

### Applications

