

14.207.14

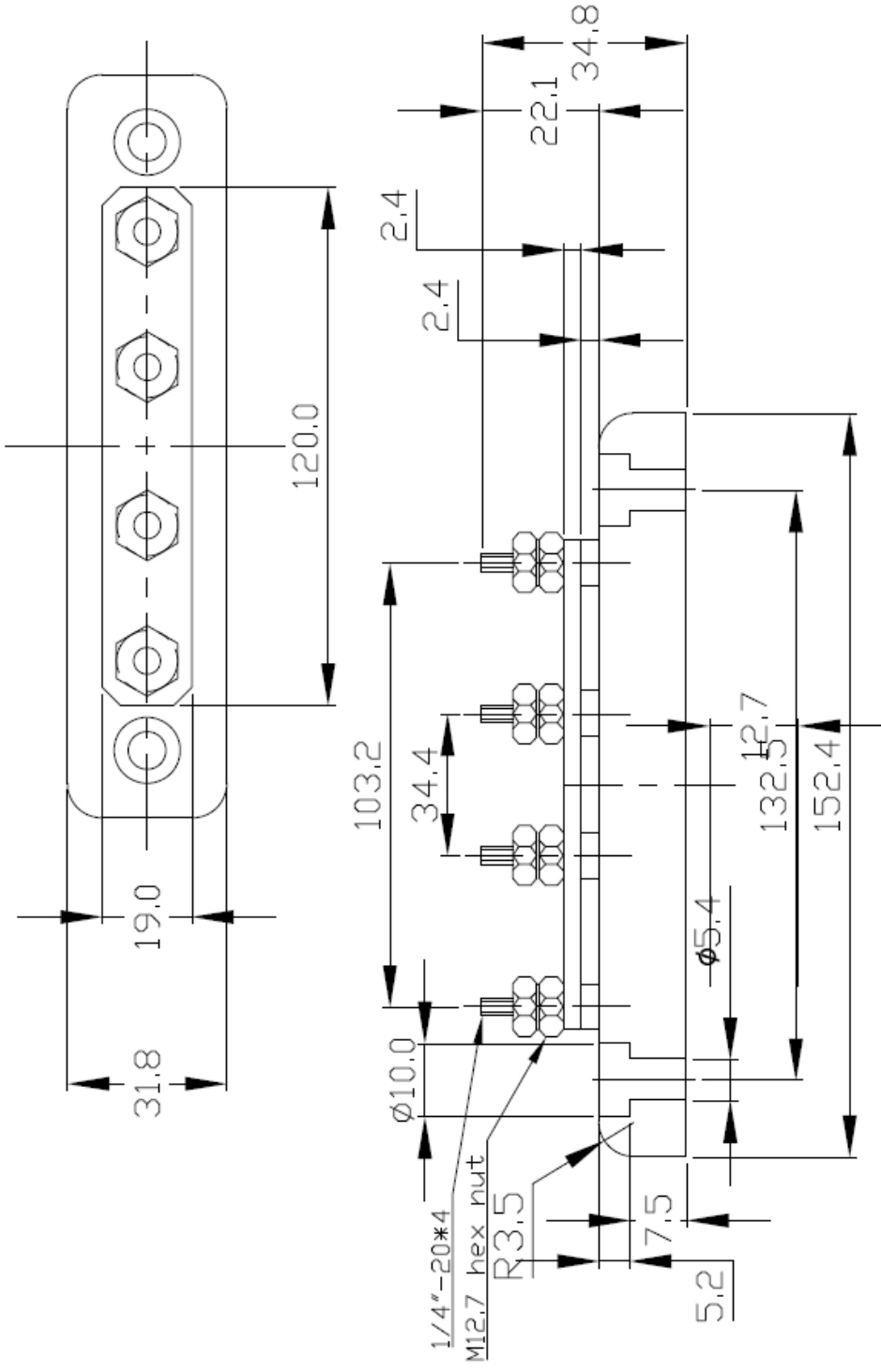

Specifications :

Continuous Amperage : 150 Amperes DC

Voltage Rating : 48 Volts DC Maximum

Terminals : 1/4"-20 x 4 stainless steel studs with hex nuts and spring washer included.

Mounting : two slot holes for #10 (3/16") mounting screws.

Dimensions : (L x W x H) : 6" x 1 1/4" x 1 3/8" (152.4mm/m x 31.75mm/m x 34.8mm/m)